

EDUARDO TORROJA
OFICINA TECNICA DE INGENIERIA
MADRID

Datos del V^{to} Antiguo.
Tomados por el Sr. Daza

Fecha 10-32

Núm. 194502

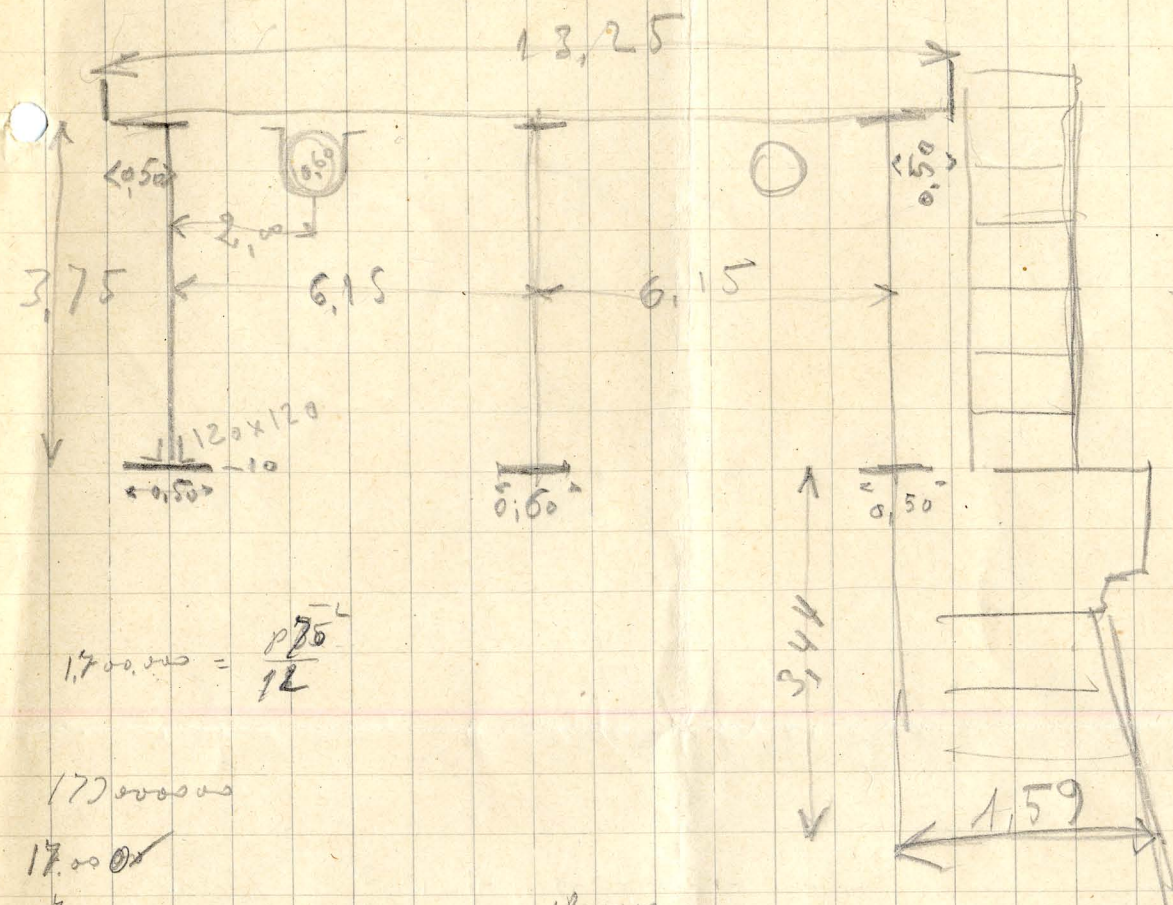

04
8
352
228
375
1

$$17000000 = \frac{275^2}{12}$$

17000000

17.000

68.000

4000 kg/ml

11.80

11.00

10.50 a ojos

20.00

9.40

4.70

5.20

2.60

1800000

4 x 40 x 35 x 300

1700000

$$\frac{20 \times 70^2}{11} = \frac{8000 \text{ m}^2}{11}$$

7.5

8000

2.5

$$\frac{2000}{60 \times 80} = \frac{2000000}{5000000} = 4000 \text{ kg}$$

16
2
48

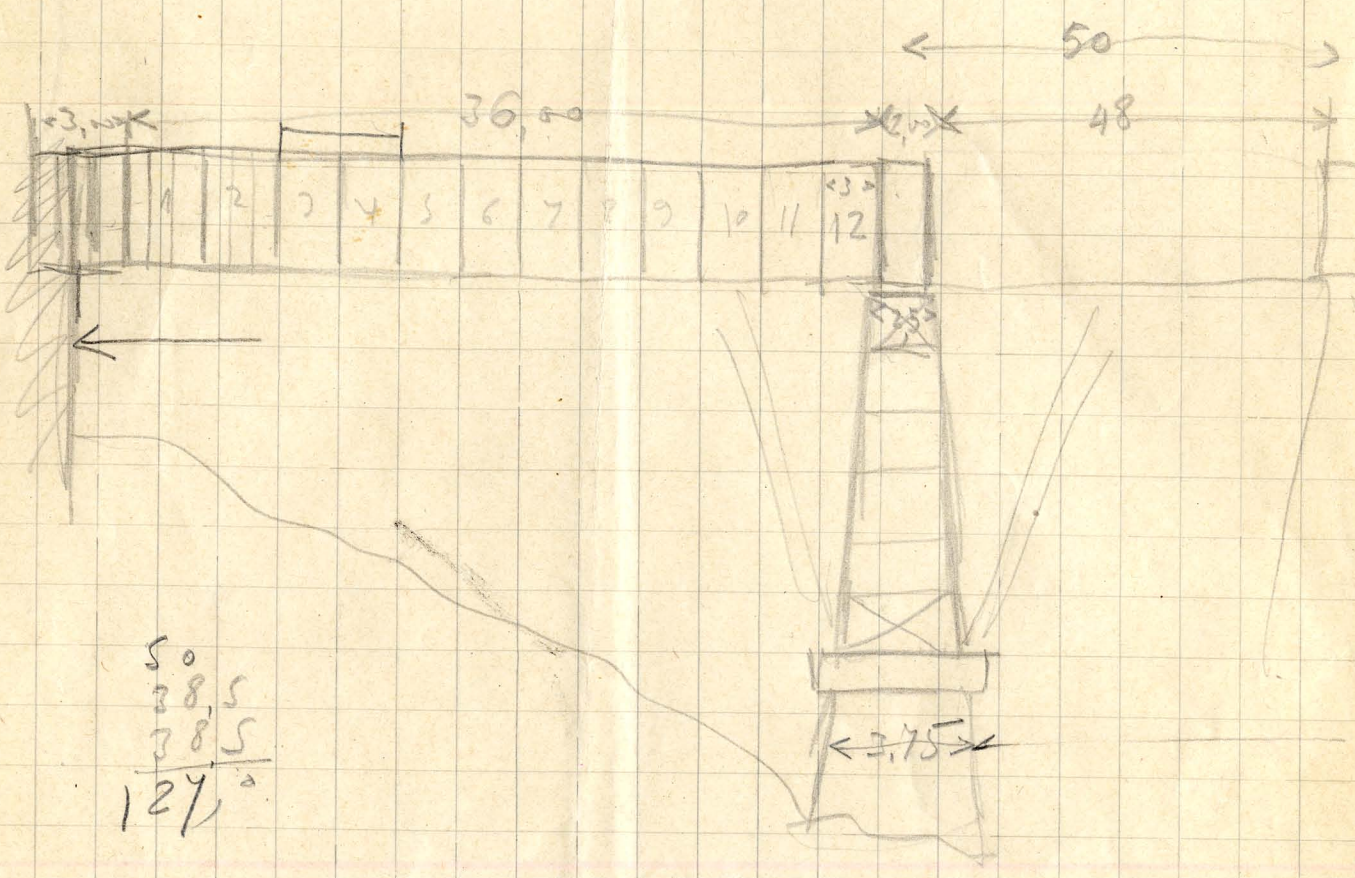

50
38,5
38,5

127,0

645
250

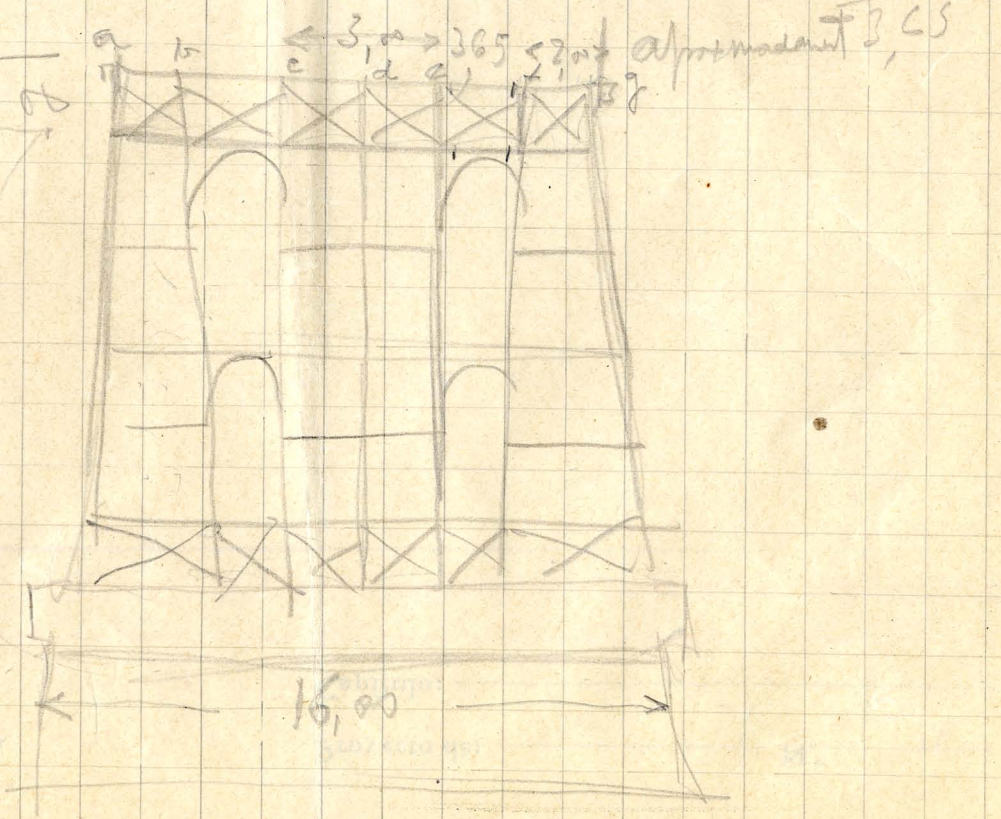
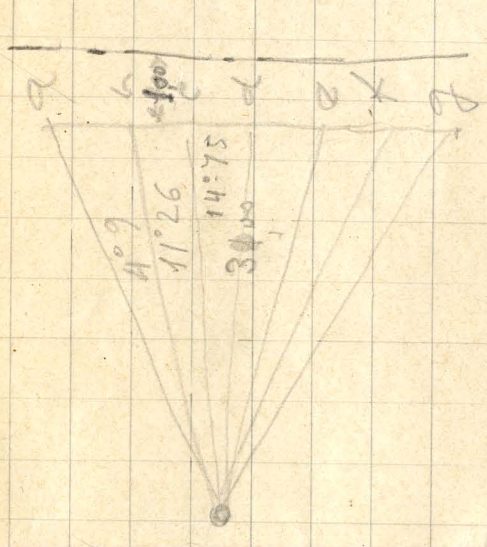

ARABISCHER DEBID
KUNSTWERKSTÄTTEN
KUNSTWERKE